

合格证  
QC PASS

Godox

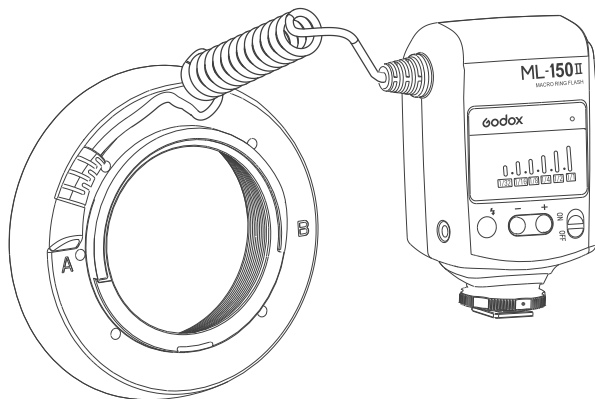

Wechat  
Official Account  
神牛微信公众号

深圳市神牛摄影器材有限公司

地址: 深圳市宝安区福海街道塘尾社区福川工业区厂房2栋 电话: 0755-29609320(8062)

传真: 0755-25723423 邮箱: godox@godox.com

GODOX Photo Equipment Co.,Ltd.

Add.: Building 2, Yaochuan Industrial Zone, Tangwei Community, Fuhai Street, Bao'an District,

Shenzhen 518103, China Tel: +86-755-29609320(8062) Fax: +86-755-25723423

E-mail: godox@godox.com

godox.com

Made in China | 705-ML1520-00



# ML-150 II

微距环形闪光灯  
Macro Ring Flash

使用手册  
Instruction Manual

## 前言

感谢您购买神牛产品ML-150 II。

微距环形闪光灯ML-150II拥有高精度档位调节、节电休眠模式、支持PC同步等诸多特性。该机广泛应用于口腔医疗摄影、珠宝摄影、微小生物摄影、服装细节摄影、手表精密细节摄影等拍摄场景。

## 主要特点:

适合镜头口径: 49mm、52mm、55mm、58mm、62mm、67mm、72mm、77mm

具备档位微调功能,可在1/1-1/32档位间以 $\pm 1/2EV$ 调节

单点触发热靴,通用市面上绝大多数相机机型使用

## 警告

- ▲ 本产品不防水,请勿本产品淋雨或受潮,以免发生火灾或触电。
- ▲ 本产品内部有高压元件,切勿自行拆解或维修,如果接触产品内部的高压电路,可能会触电。产品需修理时请送往指定地点进行专业维修。
- ▲ 如果在使用中挤压、跌落或撞击本产品,可能会造成外壳破裂。产品出现破裂后,请勿继续使用,以免接触到内部电子元件造成电击伤害。
- ▲ 请勿近距离将闪光灯头正对人眼闪光(特别是婴儿的眼睛),否则可能会在短时间内造成视力障碍。
- ▲ 在使用闪光灯拍摄婴儿时,建议闪光灯距人至少一米以上;或使用反射闪光减少闪光可能对视力造成的伤害。
- ▲ 请将电池或容易误吞的东西,远离儿童存放,如果误吞了物体,请立即就医。
- ▲ 如果电池内部腐蚀性液体流出,请戴手套将电池取出。
- ▲ 请勿在化学品或某些特殊物质、可燃性气体附近用闪光灯,这些物质在特殊情况下可能对闪光灯发出的瞬间强光敏感,有可能导致火灾或电磁干扰;在这些场合请注意相关警告标识。
- ▲ 请勿将本产品放置在超过40摄氏度的环境下;(如:汽车尾箱),有可能对元器件造成损坏。
- ▲ 长时间不使用本产品时,建议取出电池,然后存放在干燥通风地方。

## 产品结构

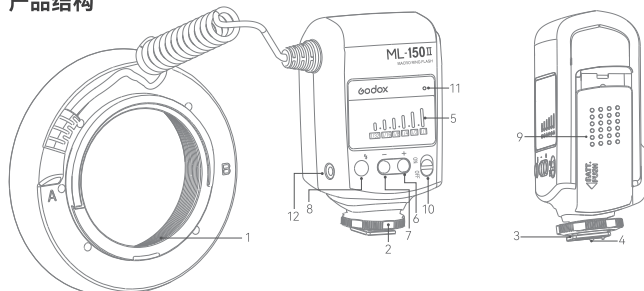

1. 环形闪光灯头
2. 固定旋钮
3. 热靴
4. 热靴触点
5. 功率指示灯
6. 功率+键
7. 功率-键
8. 试闪按钮
9. 电池盖
10. 电源开关
11. 充电指示灯
12. 同步插孔

## 标配物品

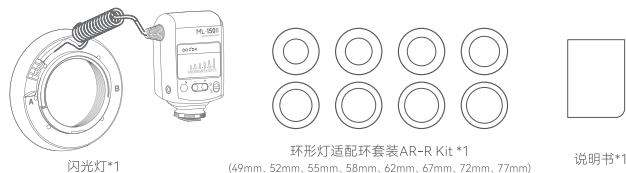

## 使用说明

### 电池安装

#### 1. 打开电池仓盖

按照箭头所示方向,用您的拇指向下滑动电池盖,即可打开电池仓盖。

#### 2. 安装电池

按照电池仓上的指示,分清电池正负触点后,一一放入四节AA电池。

#### 3. 关闭电池仓盖

按箭头所示方向滑动电池盖将其关闭。在电池仓盖发出咔嚓一声,表示该电池盖被锁定。

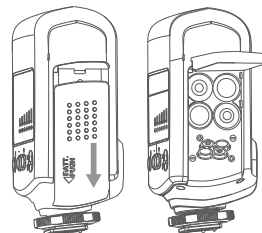

注意：在连续闪光后更换电池，请小心取出电池，因为电池可能会很烫。不使用闪光灯时，请将电池取出，以免电池漏液损坏闪光灯。

## 将闪光灯安装到相机上

### 1. 安装闪光灯控制器

- 旋松固定座上的旋钮。
- 滑动闪光灯固定座使其完全插入相机热靴插座。
- 将固定座上的旋钮旋紧直至闪光灯被锁住

提示：如若卸下闪光灯控制器，先将固定旋钮松开，再将微距闪光灯从相机热靴座上滑出。

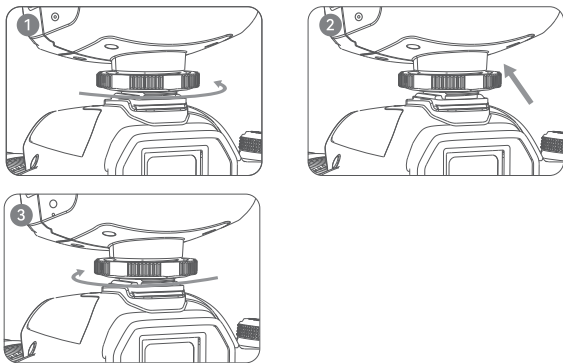

### 2. 安装闪光灯灯头

- 本产品配有8种规格适配环：49mm、52mm、55mm、58mm、62mm、67mm、72mm、77mm。
- 选择对应的适配环安装在相机镜头上。
- 将环形闪光灯头扣在转接环上。

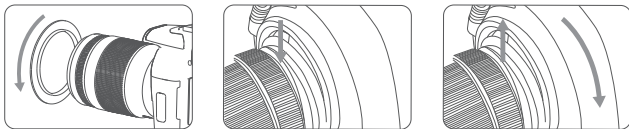

## 开关机

将电源开关机拨至ON，则表示开机。

将电源开关机拨至OFF，则表示关机。

## 充电指示灯状态说明

闪光灯处于开机时，充电指示灯为红灯，表示可以拍摄。

当充电指示灯闪烁，周期为1秒时，表示当前电池电量不足，请及时更换电池。

## 功率选择

本机有6档功率选择 (1/32-1/1)，每档以1/2档为增量。

短按一次+按键，功能档位增加1/2档。短按一次-按键，功能档位减少1/2档。

## 快门同步功能

用PC线连接相机与闪光灯，可实现与快门同步触发闪光。

注：PC线需另购。

## 省电功能

本灯具备节能模式，闪光灯超过30分钟无人操作，将自动进入省电状态。进入省电模式后，如需打开闪光灯，请按任意键。

## 保护功能

为防止闪光灯头过热导致损坏，请勿在1/1功率档位时进行超过50次的快速连续闪光。50次快速连续闪光后，要让闪光灯至少冷却5分钟，如您操作超过50次连续闪光后，马上继续进行更多次连续闪光，内部的防过热功能可能会被激活，使回电时间变到7秒左右。如果发生这种现象，请让闪光灯冷却5分钟，闪光灯便会恢复正常。

连续闪光保护对应表：

功率	闪光次数 (约值)
1/1	50
1/2 +0.5	75
1/2	100
1/4 +0.5	150
1/4	200
1/8 +0.5	300
1/8	400
1/16 +0.5	500
1/16	600
1/32 +0.5	700
1/32	800

## 系统过热保护

当内部系统过热时,说明闪光灯过度使用,内部电路将自动关闭。闪光灯需等系统温度下降(停止操作5分钟左右),闪光灯便会恢复正常。

## 规格参数

型号	ML-150II
电池	4*AA碱性电池
闪光指数	GN12(ISO 100, 以米为单位)
闪光次数	300—1000次(使用AA碱性电池)
回电时间	约0.1~2s(使用AA碱性电池)
色温	5800K±200K
闪光持续时间	1/200S-1/5000S
尺寸	控制器: 116*71*48mm
	灯头: 132*132*32mm
净重	0.42kg

## Foreword

Thank you for purchasing!

Macro ring flash ML-150II has highly precise output power adjustment, power-saving dormancy mode and PC sync function. It is quite suitable for medical photography, jewelry photography, microbiological photography, clothing detail photography and watch precision detail photography.

## Main Features

Compatible lens diameter: 49mm, 52mm, 55mm, 58mm, 62mm, 67mm, 72mm, 77mm.  
Support fine adjustment of output power from 1/1 to 1/32 in ±1/2EV stop.  
Single triggering hot shoe contact is compatible with most cameras on market.

## Warning

- ▲ Always keep this product from rain or damp in order to prevent fire or electric shock.
- ▲ The flash unit contains high voltage electric parts, do not try to open or repair the flash unit. If you touch the high-voltage circuit inside this product, electric shock may occur. Return it back to the nominated repair service station.
- ▲ If the unit is extruded, fallen, suffered from strong impact and thus its inside is exposed, stop using immediately so as to prevent electric shock leading from touching the inside electric components.
- ▲ Do not fire the flash direct to the eyes at short distances (especially baby's eyes), or it may cause damage to the eyes. When taking flash picture toward baby, it is recommended to keep the flash unit at least 1 meter (3.3 feet) away from the subject. Or use diffuser or bounce the light to soften its intensity.
- ▲ Always keep the battery or anything easy to be gulped out of children's reach. In case of gulping due to carelessness, please contact a doctor immediately.
- ▲ When there is caustic liquid leakage inside, it is necessary to wear gloves to take out the batter.
- ▲ Do not use the flash unit in the flammable gas, chemical or such liquids. These materials may be sensitive to the flash from the unit in some circumstance. It may cause fire or electromagnetic interference.
- ▲ Do not leave or store the flash unit in temperature over 40°C (such like in the automobile), or it may damage the electronic components.
- ▲ The flash unit isn't water resistant. Please keep it away from rain or humidity.
- ▲ If the flash unit is idle for long, please take out all batteries and keep the flash unit in dry area.

## Name of Parts

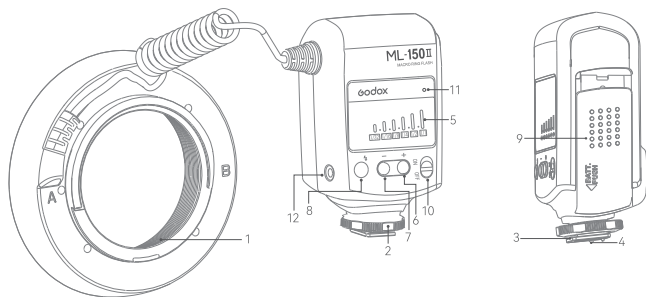

1. Ring Flash Head
2. Locking Ring
3. Hot Shoe
4. Hot Shoe Contact

5. Output Level Indicator
6. Power + Button
7. Power - Button
8. Test Button

9. Battery Cover
10. Power Switch
11. Charging Indicator
12. PC Sync Socket

## What's Inside

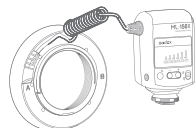

Macro Ring Flash \*1



Adapter Rings Kit AR-R Kit (49mm, 52mm, 55mm, 58mm, 62mm, 67mm, 72mm, 77mm) \*1



Instruction Manual\*1

## Operation Instruction

### Battery Installation

1. Open the battery cover

Slide the battery cover along the arrow direction and then open it by thumb.

2. Insert the batteries

Install the batteries according to the direction indicated in the battery holder and make sure the + and - battery contacts are correctly inserted at the battery compartment.

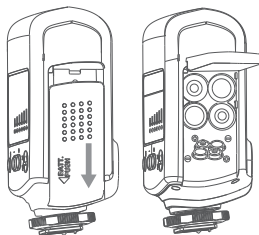

3. Close the battery cover

Slide the battery cover along the arrow direction and slide it back in place. The battery cover will be locked when there is a "click" sound.

Note: Take care of the hot battery when changing them after continuous flashes.  
Take out of the battery when idle in case the battery leakage damages the flash unit.

## Mounting Macro Ring Flash on the Camera

### 1. Attach the Control Unit on the Camera

- Twist the mounting lock to loosen it.
- Slide the mounting foot of control unit into the camera's hot shoe completely.
- Twist the mounting lock to tighten it.

Tip: To remove the flash, loosen the fixed knob and slide it out of the hot shoe of camera.

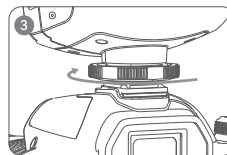
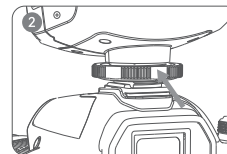
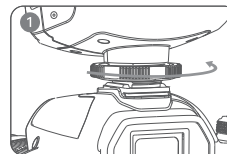

### 2. Attach the Flash Ring on the Camera.

- 8 types of adapter rings available to suit the camera lens: 49mm, 52mm, 55mm, 58mm, 62mm, 67mm, 72mm and 77mm.
- Choose the adapter ring needed for your camera and attach to the camera lens.
- Mount the flash ring onto the adapter ring.

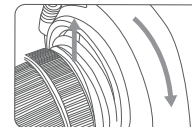
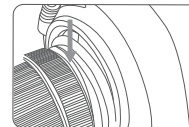
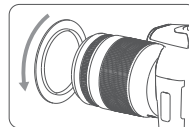

## Power Switch

Switch the power switch to ON position to power on.  
Slide the power switch to OFF position to power off.

## Charging Indicator Instruction

Turn the flash on, the charging indicator turns red and it is ready to shoot.  
If the charging indicator lamp blinks red in every 1s, it indicates low battery. In such case, please replace the batteries.

## Output Control

The flash unit has 6 stops of power output control from 1/32 to 1/1 in 1/2 stop of increment.  
Press + button to increase power by 1/2 stop, otherwise, press - button to decrease power by 1/2 stop.

## Synchronization Function

The flash and camera will trigger synchronously by using a PC sync cord to connect the sync terminals of the camera and the flash together.  
Note: PC sync cord is sold separately.

## Power Saving Function

The flash unit is equipped with power saving mode. When idle for about 30 minutes, it will enter deeper sleep state automatically to save power. To restart the unit, just press any button.

## Protection Function

To prevent the flash head from getting too hot and damage, please do not flash over 50 times when in power level 1/1. Please cool down the flash unit for at least 5 minutes.  
The over-temperature protection function will be activated if you continue to flash after 50 times. In this case, the charging time will turn to 7s. Please cool down the flash unit around 5 minutes and it will turn to normal state.

Number of flashes that will activate over-temperature protection:

Power Output	Flashes (Approx.)
1/1	50
1/2 +0.5	75
1/2	100
1/4 +0.5	150
1/4	200
1/8 +0.5	300
1/8	400
1/16 +0.5	500
1/16	600
1/32 +0.5	700
1/32	800

## Systematic Over-temperature Protection

When the inner circuit is over-heating, which indicates over use of the flash unit, the inner circuit will shut down power automatically. The flash unit will turn to normal state after the inner circuit is cooled down (about 5 minutes).

## Technical Data

Model	ML-150II
Power Supply	4*AA alkaline batteries
Guide Number	GN12(ISO 100, in meter)
Flash Times	300—1000 times (AA alkaline batteries used)
Recycle Time	Approx. 0.1~2s (AA alkaline batteries used)
CCT	5800K±200K
Flash Duration	1/200S—1/5000S
Dimension	Controller: 116*71*48mm
	Flash Head: 132*132*32mm
Net Weight	0.42kg

## FCC Statement

This device complies with part 15 of the FCC Rules. Operation is subject to the following two conditions:

- (1) This device may not cause harmful interference, and
- (2) this device must accept any interference received, including interference that may cause undesired operation.

Any Changes or modifications not expressly approved by the party responsible for compliance could void the user's authority to operate the equipment.

Note: This equipment has been tested and found to comply with the limits for a Class B digital device, pursuant to part 15 of the FCC Rules. These limits are designed to provide reasonable protection against harmful interference in a residential installation. This equipment generates uses and can radiate radio frequency energy and, if not installed and used in accordance with the instructions, may cause harmful interference to radio communications. However, there is no guarantee that interference will not occur in a particular installation. If this equipment does cause harmful interference to radio or television reception, which can be determined by turning the equipment off and on, the user is encouraged to try to correct the interference by one or more of the following measures:

- Reorient or relocate the receiving antenna.
- Increase the separation between the equipment and receiver.
- Connect the equipment into an outlet on a circuit different from that to which the receiver is connected.
- Consult the dealer or an experienced radio/TV technician for help.

## Declaration of Conformity:

GODOX Photo Equipment Co.Ltd, hereby declares that the This equipment are in compliance with the essential requirements and other relevant provisions of EU Directive 2014/35/EU· 2014/30/EU. They are allowed to be used in all EU member state.

For more information of DoC, Please click this web link:

[https://www.godox.com/DOC/Godox\\_ML-150II\\_DOC.pdf](https://www.godox.com/DOC/Godox_ML-150II_DOC.pdf)

## 产品保修

尊敬的用户,本保修卡是申请保修服务的重要凭证,请您配合销售商填写并妥善保管,谢谢!

产品信息	型号	产品条码
用户信息	姓名	联系电话
	通信地址	
销售商信息	名称	
	联系电话	
	通信地址	
	销售日期	
备注		

注:此表应由销售商盖章确认。

### 产品信息

本文件适用于相关《产品保修信息》(见后面说明)所列产品,其他非属此范围的产品或部件(如促销品、赠品及其他出厂后附加的部件等)不在此保修承诺内。

### 保修期

产品及部件的相应保修期按相关的《产品保修信息》执行。保修期自产品首次购买日起算,购买日以购买产品时保修卡登记日期为准。

### 如何获得保修服务

您可直接与产品销售商或授权服务机构联系,也可拨打神牛产品售后服务电话,与我们联系,由我们的服务人员为您安排服务。申请保修时,您应提供有效的保修卡作为保修凭证,方可获得保修。如您不能提供有效的保修卡,则在我们确认产品或部件属于保修范围的情况下,也可以为您提供保修,但这不作为我们的义务。

### 不适用保修的情况

如产品存在下列情况,本文件项下的保证和服务将不适用: ①产品或部件超过相应保修期; ②错误或不适当使用、维护或保管导致的故障或损坏,如:不当搬运;非按产品合理预期用途使用;不当插拔外接设备;跌落或外力挤压;接触或暴露于不适当温度、溶剂、酸碱、水浸或潮湿环境; ③由非神牛授权机构或人员安装、修理、更改、添加或拆卸造成的故障或损坏; ④产品或部件原有识别信息被修改变更或删除; ⑤无有效保修卡; ⑥使用非合法授权、非标准或非公开发行的软件造成的故障或损坏; ⑦因不可抗力或意外事件造成的故障或损坏; ⑧其他非因产品本身质量问题导致的故障或损坏。遇上述情况,您应向相关责任方寻求解决,神牛对此不承担任何责任。因非在保修期或保修范围内的部件、附件或软件导致产品不能正常使用的,不是保修范围内的故障。产品使用过程中正常的脱色、磨损和消耗,不是保修范围内的故障。

## 产品保修和服务支持信息

产品的保修期和服务类型按以下《产品保修信息》执行:

产品类别	选件名称	保修期(月)	保修服务类型
部件	主机	12	客户送修
	电池	3	客户送修
	充电器等带电性能的部件。	12	客户送修
其他	如电源线、同步线闪光灯管、造型灯泡、外壳、保护罩、锁紧装置、包装等。	无	无保修

神牛产品售后服务电话 0755-29609320-8062

## Warranty

Dear customers, as this warranty card is an important certificate to apply for our maintenance service, please fill in the following form in coordination with the seller and safe-keep it. Thank you!

Product Information	Model	Product Code Number
Customer Information	Name	Contact Number
	Address	
Seller Information	Name	
	Contact Number	
	Address	
	Date of Sale	
Note		

Note: This form shall be sealed by the seller.

### Applicable Products

The document applies to the products listed on the Product Maintenance Information (see below for further information). Other products or accessories (e.g. promotional items, giveaways and additional accessories attached, etc.) are not included in this warranty scope.

### Warranty Period

The warranty period of products and accessories is implemented according to the relevant Product Maintenance Information. The warranty period is calculated from the day (purchase date) when the product is bought for the first time. And the purchase date is considered as the date registered on the warranty card when buying the product.

### How to Get the Maintenance Service

If maintenance service is needed, you can directly contact the product distributor or authorized service institutions. You can also contact the Godox after-sale service call and we will offer you service. When applying for maintenance service, you should provide valid warranty card. If you cannot provide valid warranty card, we may offer you maintenance service once confirmed that the product or accessory is involved in the maintenance scope, but that shall not be considered as our obligation.

### Inapplicable Cases

The guarantee and service offered by this document are not applicable in the following cases: ① The product or accessory has expired its warranty period; ② Breakage or damage caused by inappropriate usage, maintenance or preservation, such as improper packing, improper usage, improper plugging in/out external equipment, falling off or squeezing by external force, contacting or exposing to the improper temperature, solvent, acid, base, flooding and damp environments, etc; ③ Breakage or damage caused by non-authorized institution or staff in the process of installation, maintenance, alternation, addition and detachment; ④ The original identifying information of product or accessory is modified, alternated, or removed; ⑤ No valid warranty card; ⑥ Breakage or damage caused by using illegally authorized, nonstandard or non-public released software; ⑦ Breakage or damage caused by force majeure or accident; ⑧ Breakage or damage that could not be attributed to the product itself. Once met these situations above, you should seek solutions from the related responsible parties and Godox

assumes no responsibility. The damage caused by parts, accessories and software that beyond the warranty period or scope is not included in our maintenance scope. The normal discoloration, abrasion and consumption are not the breakage within the maintenance scope.

## Maintenance and Service Support Information

The warranty period and service types of products are implemented according to the following Product Maintenance Information:

Product Type	Name	Maintenance Period(month)	Warranty Service Type
Parts	Circuit Board	12	Customer sends the product to designated site
	Battery	3	Customer sends the product to designated site
	Electrical parts e.g.battery charger, etc.	12	Customer sends the product to designated site
Other Items	Flash tube, power cord, sync cable,modeling lamp,lamp body, lamp cover,lockingdevice, package, etc.	No	Without warranty

Godox After-sale Service Call +86-755-29609320(8062)