

合格证

QC PASS



Wechat
Official Account
神牛微信公众号

深圳市神牛摄影器材有限公司

地址：深圳市宝安区福海街道塘尾社区耀川工业园厂房 2 栋

电话：0755-29609320 (8062) 传真：0755-25723423

邮箱：godox@godox.com

GODOX Photo Equipment Co., Ltd.

Add.: Building 2, Yaochuan Industrial Zone, Tangwei Community, Fuhai Street,
Bao'an District, Shenzhen 518103, China Tel: +86-755-29609320(8062)

Fax: +86-755-25723423 E-mail: godox@godox.com

www.godox.com

Made in China | 705-TT5203-00



Godox

迅丽机顶闪光灯

THINKLITE Camera Flash

TT520^{III}

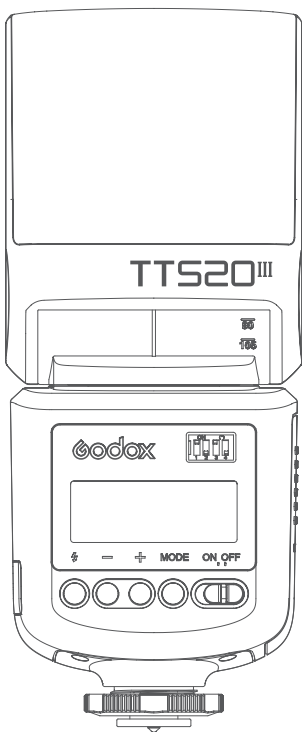

使用手册

Instruction Manual

关于本手册

本手册操作说明假定相机和机顶闪光灯的电源开关已开启。

本手册中，▲ 此图标所列事项是为避免产生拍摄问题，您需要注意的事项，● 此图标所列信息是文中某项功能的补充信息。

重要安全提示

本产品属于专业摄影设备，需要专业人员操作使用。使用前必须拆除产品上的所有运输保护材料和包装。使用时必须遵守以下基本安全预防措施：

1. 使用本产品前，请仔细阅读并完全理解产品说明书，严格按照说明书中的安全提示操作。否则，可能导致死亡、严重伤害、产品损坏或其他财产损失的安全隐患。
2. 本产品为专业灯具，儿童禁止使用。儿童接近时，成人必须密切监督，防止儿童碰撞灯具或私自使用灯具，造成人身伤害。
3. 本灯具并非普通灯具，不可用于普通照明，任何有眼部损伤或眼部敏感的人群均应避免使用本灯具或直视本灯具，光敏性癫痫患者禁用。
4. 使用时必须小心，严禁接触如闪光管等高温部件，以避免烫伤。
5. 任何情况下均禁止将闪光灯直接对准人眼（特别是婴儿眼睛），否则短时间内可能导致视力损伤。如感到眼睛不适，应立即关闭灯具，停止使用并及时就医。
6. 闪光管损坏时，应立即停止使用，及时联系制造商、服务代理商或合格维修人员更换，以防发生事故。
7. 严禁使用损坏的设备或配件，必须等待专业维修人员检查维修并确认设备正常后，才可继续使用。
8. 更换灯管、保护玻璃或保险丝前，必须断开电源或者拆下电池（如装有电池），确保灯具与电源完全断开。更换灯管前让其冷却 10 分钟，操作时需戴绝缘 / 或隔热手套。
9. 使用过程中，如果产品因跌落、挤压或强力冲击导致外壳破裂，应立即停止使用，避免接触内部电子部件而触电受伤。
10. 本设备不防水，请保持干燥，不能浸入水或其他液体。应安装在通风干燥位置，避免在雨天、潮湿、多尘或过热环境中使用。不要在设备上放置物品，或让液体流入内部，防止发生危险。
11. 未经授权，请不要自行拆卸本产品。产品若出现故障，必须由本公司或授权维修人员检查和维修。
12. 请勿将设备放置在酒精、汽油等易燃挥发性溶剂或气体如甲烷、乙烷等附近。
13. 本设备禁止在有爆炸危险的环境中使用或存放。
14. 运行期间和之后，设备灯头与用户和其他人员，以及热敏或可燃物品之间，距离必须始终保持至少 1 米。
15. 严禁覆盖设备散热口！
16. 请勿使用未经本公司认可的配件，以免造成火灾、触电或人身伤害。
17. 清洁设备时，请用干燥软布轻轻擦拭，不可使用湿布，否则可能会损坏设备。
18. 使用 AA 电池供电，请注意：
 - 只能使用产品说明书中指定的电池或电源；
 - 请将电池及其他小配件放在儿童和婴幼儿接触不到的位置。如果误吞食电池或小配件，请立即就医；
 - 如果电池漏液、变色、变形、冒烟或散发异味，请立即取出电池。操作时请小心，避免烫伤。继续使用可能引起火灾、电击或皮肤烫伤；
 - 不要使用任何变形或改装过的电池；
 - 不要拆卸或改装产品或电池；
 - 不要加热、焊接电池，或让电池接触火或水；
 - 避免电池受到强力撞击；
 - 请勿将电池的正负端错误插入，或将新旧电池或不同类型的电池混合使用。
19. 处理任何电池前，请确认并遵守当地相关法律法规。
20. 本使用说明基于严格测试制定，设计和规格变更恕不另行通知。您可登录我们官方网站查看最新电子版使用说明，了解产品最新资讯。
21. 本设备整机的保修期为一年。
22. 私自维修将取消保修资格，需支付维修费用。
23. 不当操作导致故障不在保修范围。

前言

感谢您购买神牛产品。

TT520III 主要特点

- M 手动模式具备 8 档功率，可在 1/128~1/1 全功率间以 $\pm 1/3$ 档调节。
- 支持 S1/S2 光控，可在多灯闪光系统作副灯使用。
- 支持无线触发，使用标配发射器无线触发闪光。
- 灯头上下可旋转 $-7^{\circ} \sim 120^{\circ}$ ，左右可旋转 $0^{\circ} \sim 330^{\circ}$ 。
- 内置反射板和广角扩散板，创意无限。

部件名称

闪光灯

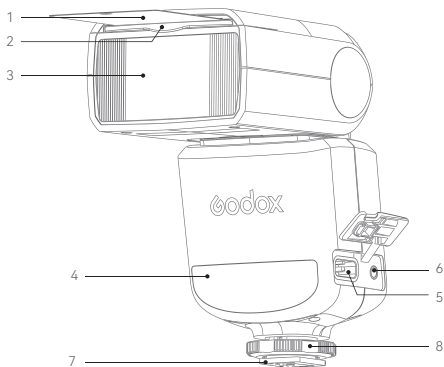

- 1. 反射板
- 2. 广角扩散板
- 3. 闪光灯头
- 4. 无线传感器

- 5. 外接电源盒接口（可外接电源盒 PB960，需另购）
- 6. 同步插孔（使用同步线连接相机与闪光灯，即可同步触发）
- 7. 热靴
- 8. 热靴锁环

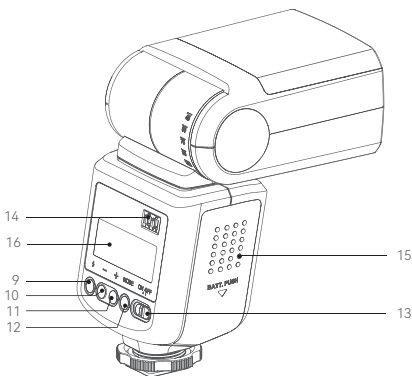

- 9. 试闪按键（测试闪光，可短按此键）
- 10. 功率 - 按键
- 11. 功率 + 按键
- 12. 模式按键（短按切换 S1/S2，长按开启或关闭无线）

- 13.ON/OFF 按键（ON 开机，OFF 关机）
- 14. 频道编码（当 RT 发射器频道编码与 TT520III 频道编码一致，即可触发闪光）
- 15. 电池仓（往下滑动即可打开，插入四节 AA 电池）
- 16. 显示屏

RT 发射器

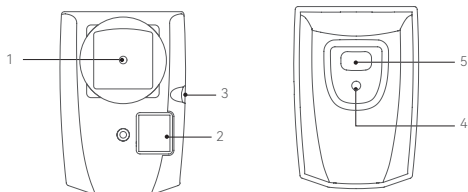

- 1. 热靴
- 2. 频道编码
- 3. 同步线插孔

- 4. 指示灯
- 5. 试闪按键

物品清单



机顶闪光灯 ×1



RT 发射器 ×1



微型底座 ×1

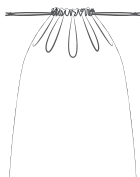

收纳袋 ×1



说明书 ×1

安装闪光灯 / 拆卸闪光灯

安装：滑动闪光灯热靴使其完全插入相机热靴插座，随后顺时针旋转锁环直至闪光灯被锁住。

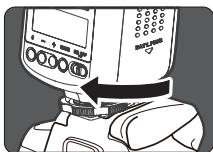
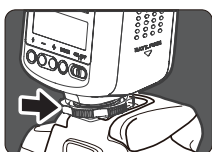

拆卸：逆时针旋转锁环，随后取下闪光灯。

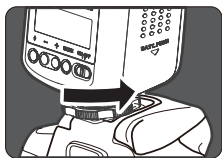

安装电池

安装：按照图 1 箭头方向滑开电池仓，分清电池正负极后插入四节电池，图 2 展示的是电池上方的正负极，最后按照图 3 箭头方向滑动电池仓关闭。



- ▲ 1. 在连续闪光后更换电池，请务必小心，可能有点烫。
- 2. 不使用闪光灯时，请务必取出电池，以免电池泄露损坏闪光灯。

开机 / 关机

将 ON/OFF 按键拨至 ON，即可开机，将 ON/OFF 按键拨至 OFF，即可关机。

M：手动闪光模式

您可以在 1/128 功率至 1/1 全功率间以 $\pm 1/3$ 档设置闪光输出。为获得正确的闪光曝光，请使用手持的闪光测光表确定所需的闪光输出。

您可短按功率 - 按键或功率 + 按键调节功率。

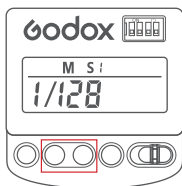

光控设置

您可短按 MODE 按键切换 S1 光控 / S2 光控。关闭光控时，屏幕不显示 S1 或 S2 图标。



S1 光控单元设置:

使用 S1 光控功能，闪光灯可作为副灯使用，创造多种照明效果，适用于手动闪光环境。它会与主闪光灯的第一次闪光同步触发闪光，效果与使用无线引闪器一致。

S2 光控单元设置:

使用 S2 光控功能，闪光灯可作为副灯使用，适用于 TTL 闪光环境；具有防预闪功能，使用带一次预闪功能的相机能用光控实现同步拍摄。它会与主闪光灯的第二次闪光同步触发闪光，即 2 次光控引闪。

无线触发

无线开 / 关: 长按 MODE 按键 2s 开启或关闭无线。开启时，屏幕出现无线符号 (Ⓜ)，关闭时，屏幕不显示无线符号。

无线触发: 闪光灯 TT520III 无线开启后，RT 发射器频道编码与 TT520III 频道编码设为一致，即可触发闪光。



反射闪光

通过将闪光灯头指向墙壁或天花板，闪光在照亮被摄体前被墙面反射。这可以减轻被摄物体背后的阴影，获得更自然的摄影效果。称之为反射闪光。

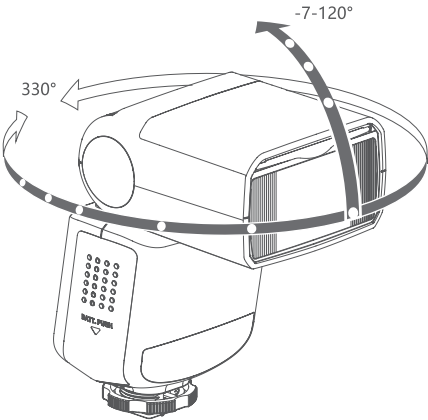

- ⚠ 1. 如果墙壁或天花板太远，反射闪光可能太弱并导致曝光不足。

2. 墙壁或天花板应该是平坦的、白色的，有利于高效的反射。

如果反射表面不是白色的，照片将出现偏色。

使用反射板拍摄

先将内置反射板和广角扩散板从灯头拉出，将广角扩散板推回。此时使用本产品拍摄，可以在主体的眼睛造成高光点，使眼睛更加迷人（眼神光），此功能在闪光灯头上仰90度时能达到最好的效果。

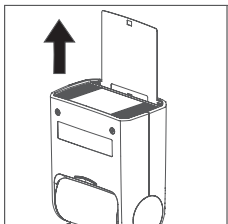

使用广角扩散板拍摄

拉出广角扩散板，使闪光范围扩大，闪光效果将更加柔和和自然。

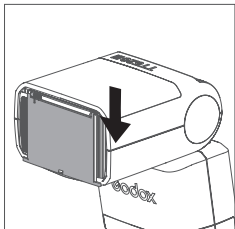

过热保护

- 为防止闪光灯头过热并损坏，请勿在1/1 档位时进行超过40 次的快速连续闪光。40 次连续闪光后，要让闪光灯至少冷却10 分钟。
- 如您在进行超过40 次连续闪光后马上继续进行更多次闪光，内部的防过热功能可能会被激活，使回电时间变为10 秒以上。如果发生这种现象，请让闪光灯冷却约10 分钟，闪光灯便会恢复正常。

激活过热保护功能的连续闪光次数：

功率档位	连续闪光次数
1/1	40
1/2	66
1/4	100
1/8	133
1/16	200
1/32	266
1/64	400
1/128	800

节能模式

节能模式：在机顶使用时，30 分钟无操作自动待机；在无线或光学引闪模式下，60 分钟无操作自动待机。您可按任意键唤醒。

频道编码的含义

频道 编码								
频道	CH01	CH02	CH03	CH04	CH05	CH06	CH07	CH08
频道 编码								
频道	CH09	CH10	CH11	CH12	CH13	CH14	CH15	CH16

规格参数

闪光灯

型号	TT520III
闪光指数	约33（ISO 100，以米为单位）
光控模式	S1 光控/S2 光控
灯头上下旋转角度	-7°~120°
灯头左右旋转角度	0°~330°
电池	4 节 5 号镍氢电池（推荐）/LR6 类型碱性电池
闪光持续时间（t0.1）	1/510s ~ 1/31000s
闪光次数（1/1 档）	约 400 次（镍氢电池）
回电时间（1/1 档）	约 1.8s（镍氢电池）
频道	16 组
无线频率	433MHz
无线传输距离（最大）	约 15 米
尺寸	182×74×72mm
净重	约 304g

RT 发射器

型号	RT-16
电源	23A（12V）锂离子电池
无线传输距离（最大）	约20 米（室内） / 约30 米（室外）
无线频率	433MHz
尺寸	60×42×30mm
净重	约31g

规格和参数如有变更，恕不另行通知。

About This Instruction Manual

- This manual is based on the assumption that both the camera and camera flash's power switches are turned on.
- The following alert symbols are used in this manual:
 - ▲ The caution symbol indicates a warning to prevent shooting problem.
 - ℹ The note symbol gives supplemental information.

Important Safety Instructions

This product is a professional photographic equipment, to be operated by professional personnel only. All transport protective materials and packaging on the product must be removed before use. The following basic safety precautions must be followed when using this product:

1. Carefully read and fully understand the instruction manual before use and strictly follow the safety instructions. Failure to do so may result in death, serious injury, damage to the product, or other property damage.
2. This product is a professional lighting fixture, children are prohibited from using it. Children must be closely supervised by adults when approaching the fixture, to prevent collisions with the fixture or unauthorized use that could cause personal injury.
3. This is not an ordinary lighting fixture and must not be used for general illumination. Anyone with a history of eye damage or sensitivity should avoid using this fixture or looking directly at it, patients with photosensitive epilepsy are prohibited to use .
4. Extreme caution must be exercised when using it, do not touch high-temperature parts such as flash tubes to avoid burns.
5. Do not point the flash directly at the eyes (especially baby's eyes) under any circumstances, as this could impair vision in a short time. Turn off immediately if discomfort occurs, stop using, and seek medical attention promptly.
6. If the flash tube is damaged, stop using it immediately and contact the manufacturer, service agent, or qualified repair personnel for a replacement to prevent accidents.
7. Stop using immediately if the product shell is cracked due to falling, squeezing, or strong impact, to avoid touching the internal electronic components and getting an electric shock.
8. Disconnect power source or remove batteries (if it has one) before replacing flash tube, protective glass, or fuses. Allowing 10 minutes to cool before replacing flash tube, and wear insulated or heat resistant gloves when operating.
9. Stop using immediately if the product shell is cracked due to falling, squeezing, or strong impact, to avoid touching the internal electronic components and getting an electric shock.
10. This device is not waterproof. Keep it dry and avoid immersing it in water or other liquids. It should be installed in a ventilated and dry location and avoid using in rainy, humid, dusty, or overheated environments. Do not place items above the device or allow liquids to flow into it to prevent danger.
11. Do not disassemble without authorization. If the product malfunctions, it must be inspected and repaired by our company or authorized repair personnel.
12. Do not place the device near alcohol, gasoline, or other flammable volatile solvents or gases such as methane and ethane.
13. Do not use or store this device in potentially explosive environments.
14. Maintain at least 1 meter distance between the lamp head and the user, other people, and heat-sensitive or flammable items during and after use.
15. Do not cover the heat dissipation port!
16. Do not use accessories not been approved by our company, as this may cause fire, electric shock or personal injury.
17. Clean gently with a dry cloth. Do not use a wet cloth as it may

damage the device.

18. This product is powered by AA batteries. Please note:
 - Use only the batteries or power sources specified in the instruction manual;
 - Keep batteries and other small accessories out of the reach of children and infants. If a battery or small accessory is accidentally swallowed, seek medical attention immediately;
 - If the battery leaks, changes color, deforms, smokes or emits an unusual smell, remove the battery immediately. Be careful during operation to avoid burns. Continued use may cause fire, electric shock, or skin burns;
 - Do not use any deformed or modified batteries;
 - Do not disassemble or modify the product or battery;
 - Avoid heating, welding, exposing the battery to fire or water;
 - Avoid strong impacts on the battery;
 - Do not mismatch positive and negative terminals of the battery, or mix old and new or different types of batteries.
19. Confirm and comply with all relevant local laws and regulations when handling any batteries.
20. This instruction manual is based on rigorous testing. Changes in design and specifications are subject to change without notice. Check official website for latest instruction manual and product updates.
21. The warranty period for this device as a whole is one year.
22. Unauthorized repairs will void the warranty and will incur charges.
23. Failures from improper operation is not covered under warranty.

Foreword

Thank you for purchasing!

Main Features

- 8 steps of power adjustable from in manual mode 1/128 to 1/1 full power with $\pm 1/3$ increment.
- Support S1/S2 photocell, workable as a secondary flash in multi-flash system.
- Wireless triggering is available with the standard transmitter.
- Flash head is vertically adjustable from -7° to 120° , horizontally adjustable from 0° to 330° .
- Built-in reflector and wide-angle diffuser for unlimited creativity.

Name of Parts

Camera Flash TT520III

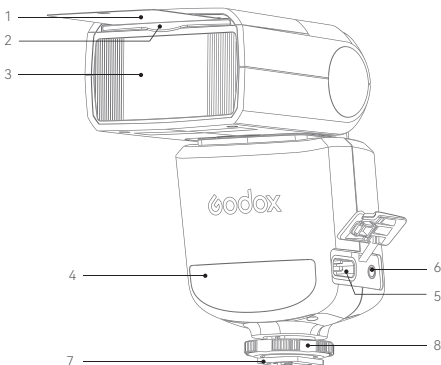

- 1. Reflector
- 2. Wide-angle Panel
- 3. Flash Head
- 4. Wireless Sensor
- 5. External Power Box Port (compatible with separately sold PB960)
- 6. Sync Cord Jack (connect the camera to the flash with sync cord to sync triggering)
- 7. Hot Shoe
- 8. Hot Shoe Lock Ring

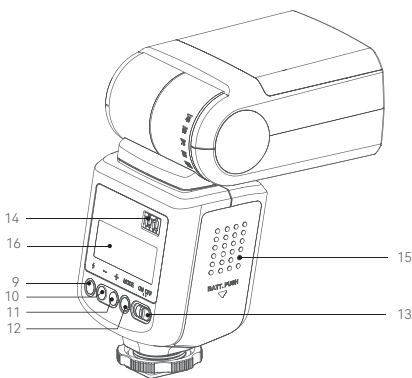

- 9. Test Button (short press to fire a testing flash)
- 10. Power - Button
- 11. Power + Button
- 12. Mode Button (short press to switch S1/S2, long press to turn on/off wireless)
- 13. ON/OFF Button (power on/ power off)
- 14. Channel (triggering flash is available when the channels of RT transmitter and TT520III are set to the same)
- 15. Battery Compartment (slide down to open then insert four AA batteries)
- 16. Display

RT Transmitter

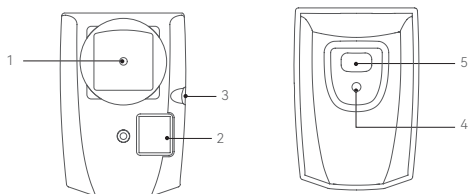

- 1. Hot Shoe
- 2. Channel Code
- 3. Sync Cord Jack

- 4. Indicator
- 5. Test Button

What's Inside



Camera Flash ×1



RT Transmitter ×1

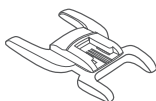

Mini Stand ×1

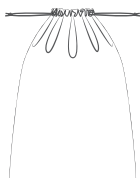

Storage Bag ×1



Instruction Manual ×1

Installing/Disassembling the Camera Flash

Installing the camera flash: Slide the hot shoe on the camera flash and insert into the camera's hot shoe base, then rotate the lock ring clockwise until it locks up.

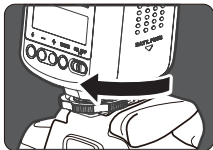
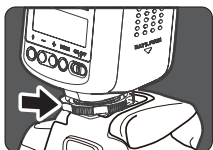

Disassembling the camera flash: Rotate the lock ring anticlockwise until it is loosened, then take off the camera flash.

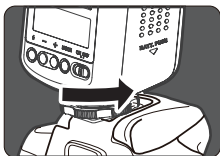

Installing the Battery

Slide and open the battery compartment according to the arrow direction in figure 1, insert four batteries in the correct positive and negative poles (figure 2 shows the positive and negative poles on the battery), finally slide the battery compartment to close according to the arrow direction in figure 3.



⚠ Attention:

1. Take care of the hot battery when changing them after continuous flashes.
2. Take out the battery when idle in case the battery leakage damages the flash unit.

Power On/Off

Switch the ON/OFF button to ON to turn on the camera, switch to OFF to turn it off.

M: Manual Flash

The flash output is adjustable from 1/128 to 1/1 full power with $\pm 1/3$ increment each step. To obtain a correct flash exposure, use a hand-held flash meter to determine the required flash output.

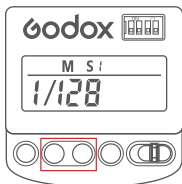

Press the power – button or power + button to adjust the power.

Photocell Settings

Press the MODE button to switch between S1 photocell and S2 photocell. The display will not show S1 or S2 icon when the photocell function is turned off.

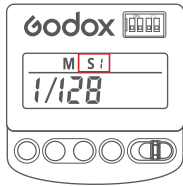

S1 Photocell Unit Setting

This flash can function as an optic S1 secondary flash with optic sensor. With this function, the flash will fire synchronously when the main flash fires, the same effect as that by the use of wireless triggers. This helps create multiple lighting effects.

S2 Photocell Unit Setting

This flash can also function as an optic S2 secondary flash with optic sensor. This is useful when cameras have pre-flash function. With this function, the flash will ignore a single "pre-flash" from the main flash and will only fire in response to the second, actual flash from the main flash.

Wireless Triggering

Wireless On/Off: Press and hold the MODE button for 2s to turn on or off the wireless function. The wireless icon ((•)) will appear on the display when the wireless function is turned on, while disappear when turned off.

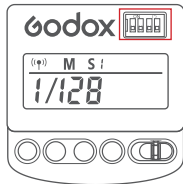

Wireless Triggering: Triggering flash is available when the channels of RT transmitter and TT520III are set to the same after the wireless function is turned on.

Bounce Flash

By pointing the flash head toward a wall or ceiling, the flash will bounce off the surface before illuminating the subject. This can soften shadows behind the subject for a more natural-looking shot. This is called bounce flash. To set the bounce direction, hold the flash head and turn it to a satisfying angle.

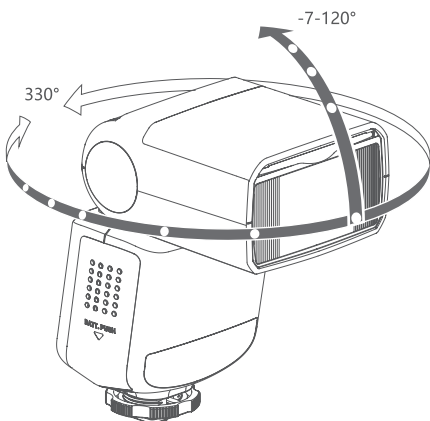

▲ Note:

1. If the wall or ceiling is too far away, the bounced flash might be too weak and result in underexposure.
2. The wall or ceiling should be a plain, white color for high reflectance. If the bounce surface is not white, a color cast may appear in the picture.

Use Reflector to Take Photos

Pull out the built-in reflector and wide-angle diffuser from the flash head at the same time and then push the wide-angle diffuser back. In such case, if this product is being used to take photos, it will produce a highlighted point on the eyes of the subject and thus make the eyes charming (catch lights). This function can reach optimal effect when the flash head is up 90°.

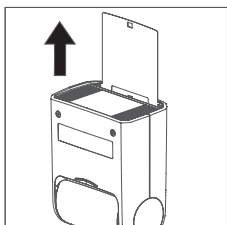

Use Wide-angle Diffuser to Take Photos

Pull out the built-in wide-angle diffuser to enlarge flash lighting range, so as to get more softened and natural lighting effect.

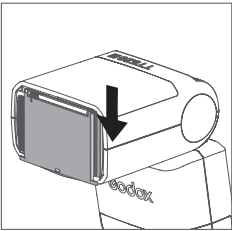

Over-Temperature Protection

- To avoid overheating and deteriorating the flash head, do not fire more than 40 continuous flashes in fast succession at 1/1 full power. After 40 continuous flashes, allow a rest time of at least 10 minutes.
- If you fire more than 40 continuous flashes and then fire more flashes in short intervals, the inner over-temperature protection function may be activated and make the recycle time over 10 seconds. If this occurs, allow a rest time of about 10 minutes, and the flash unit will then return to normal.



Number of flashes that will activate over-temperature protection:

Power Output Level	Number of Flashes
1/1	40
1/2	66
1/4	100
1/8	133
1/16	200
1/32	266
1/64	400
1/128	800

Power Saving Mode

With the power saving function, the flash will automatically enter power saving mode after 30 minutes of idle use when mounted onto a camera. In wireless flash or photocell mode, the flash will automatically enter power saving mode after 60 minutes of idle use. Pressing any flash button will wake it up.

Channel Instructions

Channel Code								
Channel	CH01	CH02	CH03	CH04	CH05	CH06	CH07	CH08
Channel Code								
Channel	CH09	CH10	CH11	CH12	CH13	CH14	CH15	CH16

Technical Data

Camera Flash

Model	TT520III
GN	Approx.33 (ISO 100, in meters)
Photocell	S1/S2
Vertically Rotatable Flash Angle	-7°~120°
Horizontally Rotatable Flash Angle	0°~330°
Battery	Four AA NIMH batteries (recommended)/LR6 alkaline batteries
Flash Duration (t0.1)	1/510s~1/31000s
Time of Flashes (1/1 step)	Approx. 400 (NIMH batteries)
Recycle Time (1/1 step)	Approx. 1.8s (NIMH batteries)
Channel	16 groups
Wireless Frequency	433MHz
Wireless Transmission Distance (Max.)	Approx. 15m
Dimension	7.17"×2.91"×2.83"
Net Weight	Approx. 304g

RT Transmitter

Model	RT-16
Power Source	23A(12V)Li-ion battery
Wireless Transmission Distance (Max.)	Approx. 20m(indoor)/Approx. 30m (outdoor)
Wireless Frequency	433MHz
Dimension	2.36"×1.65"×1.18"
Net Weight	Approx. 31g

Specifications and data may subject to changes without notice.

Warning

Operating frequency: 433.05MHz – 434.79MHz (only receive)

Declaration of Conformity

GODOX Photo Equipment Co., Ltd. hereby declares that this equipment is in compliance with the essential requirements and other relevant provisions of Directive 2014/53/EU. In accordance with Article 10(2) and Article 10(10), this product is allowed to be used in all EU member states. For more information of DoC, Please click this web link:

<https://www.godox.com/eu-declaration-of-conformity/>

The device complies with RF specifications when the device is used at 0mm from your body.

FCC Caution

This device complies with part 15 of the FCC Rules. Operation is subject to the following two conditions:

- (1) This device may not cause harmful interference, and
- (2) this device must accept any interference received, including interference that may cause undesired operation.

Any Changes or modifications not expressly approved by the party responsible for compliance could void the user's authority to operate the equipment.

IC Warning

This device complies with Industry Canada licence-exempt RSS standard(s). Operation is subject to the following two conditions:

- (1) This device may not cause interference, and
- (2) This device must accept any interference, including interference that may cause undesired operation of the device.

Le présent appareil est conforme aux CNR d'Industrie Canada applicables aux appareils radio exempts de licence. L'exploitation est autorisée aux deux conditions suivantes: (1) l'appareil ne doit pas produire de brouillage, et (2) l'utilisateur de l'appareil doit accepter tout brouillage radioélectrique subi, même si le brouillage est susceptible d'en compromettre le fonctionnement

产品保修

尊敬的用户，本保修卡是申请保修服务的重要凭证，请您配合销售商填写并妥善保管，谢谢！

产品信息	型号	产品条码
用户信息	姓名	联系电话
	通信地址	
销售商信息	名称	
	联系电话	
	通信地址	
	销售日期	
备注		

注：此表应由销售商盖章确认。

适用产品

本文件适用于相关《产品保修资讯》（见后面说明）所列产品，其他非属此范围的产品或部件（如促销品、赠品及其他出厂后附加的部件等）不在此保修承诺内。

保修期

产品及部件的相应保修期按相关的产品保修信息执行。保修期自产品首次购买日起算，购买日以购买产品时保修卡登记日期为准。

如何获得保修服务

您可直接与产品销售商或授权服务机构联系，也可拨打神牛产品售后服务电话，与我们联系，由我们的服务人员为您安排服务。申请保修时，您应提供有效的保修卡作为保修凭证，方可获得保修。如您不能提供有效的保修卡，则在我们确认产品或部件属于保修范围的情况下，也可以为您提供保修，但这不作为我们的义务。

不适用保修的情况

如产品存在下列情况，本文件项下的保证和服务将不适用：①产品或部件超过相应保修期；②错误或不当使用、维护或保管导致的故障或损坏，如：不当搬运、非按产品合理预期用途使用；不当插拔外接设备；跌落或外力挤压；接触或暴露于不当温度、溶剂、酸碱、水浸或潮湿环境；③由非神牛授权机构或人员安装、修理、更改、添加或拆卸造成的故障或损坏；④产品或部件原有识别信息被修改变更或删除；⑤无有效保修卡；⑥使用非合法授权、非标准或非公开发行的软件造成的故障或损坏；⑦因不可抗力或意外事件造成的故障或损坏；⑧其他非因产品本身质量问题导致的故障或损坏。遇上述情况，您应向相关责任方寻求解决，神牛对此不承担任何责任。因非在保修期或保修范围内的部件、附件或软件导致产品不能正常使用的，不是保修范围内的故障。产品使用过程中正常的脱色，磨损和消耗，不是保修范围内的故障。

产品保修和服务支持信息

产品的保修期和服务类型按以下《产品保修信息》执行：

产品类别	选件名称	保修期（月）	保修服务类型
部件	主机	12	客户送修
	电池	3	客户送修
	充电器等带电性能的部件。	12	客户送修
其他	如电源线、同步线、外壳、保护罩、锁紧装置、包装等。	无	无保修

神牛产品售后服务电话：0755-29609320-8062

Warranty

Dear customers, as this warranty card is an important certificate to apply for our maintenance service, please fill in the following form in coordination with the seller and safe-keep it. Thank you!

Product Information	Model	Product Code Number
Customer Information	Name	Contact Number
	Address	
Seller Information	Name	
	Contact Number	
	Address	
	Date of Sale	
Note		

Note: This form shall be sealed by the seller.

Applicable Products

The document applies to the products listed on the Product Maintenance Information (see below for further information). Other products or accessories (e.g. promotional items,giveaways and additional accessories attached,etc.) are not included in this warranty scope.

Warranty Period

The warranty period of products and accessories isimplemented according to the relevant Product Maintenance Information. The warranty period is calculated from the day(purchase date) when the product is bought for the first time,And the purchase date is considered as the date registered onthe warranty card when buying the product.

How to Get the Maintenance Service

If maintenance service is needed, you can directly contact the product distributor or authorized service institutions. You can also contact the Godox after-sale service call and we will offer you service. When applying for maintenance service, you should provide valid warranty card. If you cannot provide valid warranty card, we may offer you maintenance service once confirmed that the product or accessory is involved in the maintenance scope, but that shall not be considered as our obligation.

Inapplicable Cases

The guarantee and service offered by this document are not applicable in the following cases① **The product or accessory has expired its warranty period;** ② **Breakage or damage caused by inappropriate usage, maintenance or preservation, such as improper packing, improper usage, improper plugging in/out external equipment, falling off or squeezing by external force, contacting or exposing to the improper temperature, solvent, acid, base, flooding and damp environments, etc;** ③ **Breakage or damage caused by non-authorized institution or staff in the process of installation, maintenance, alternation, addition and detachment;** ④ **The original identifying information of product or accessory is modified, alternated, or removed;** ⑤ **No valid warranty card;** ⑥ **Breakage or damage caused by using illegally authorized, nonstandard or non-public released software;** ⑦ **Breakage or damage caused by force majeure or accident;** ⑧ **Breakage or damage that could not be attributed to the product itself.** Once met these situations above, you should seek solutions from the related responsible parties and Godox assumes no responsibility. The damage caused by parts, accessories and software that beyond the warranty period or scope is not included in our maintenance scope. The normal discoloration, abrasion and consumption are not the breakage within the maintenance scope.

Maintenance and Service Support Information

The warranty period and service types of products are implemented according to the following Product Maintenance Information:

Product Type	Name	Maintenance Period(month)	Warranty Service Type
Parts	Circuit board	12	Customer sends the product to designated site
	Battery	3	Customer sends the product to designated site
	Electrical parts e.g.battery charger, etc.	12	Customer sends the product to designated site
Other Items	Power cord, sync cable, lamp body, lamp cover,lockingdevice, package, etc.	No	Without warranty

Godox After-sale Service Call +86-755-29609320(8062)